

We support PV systems

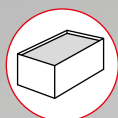

# S-Dome 6 System

## ASSEMBLY MANUAL

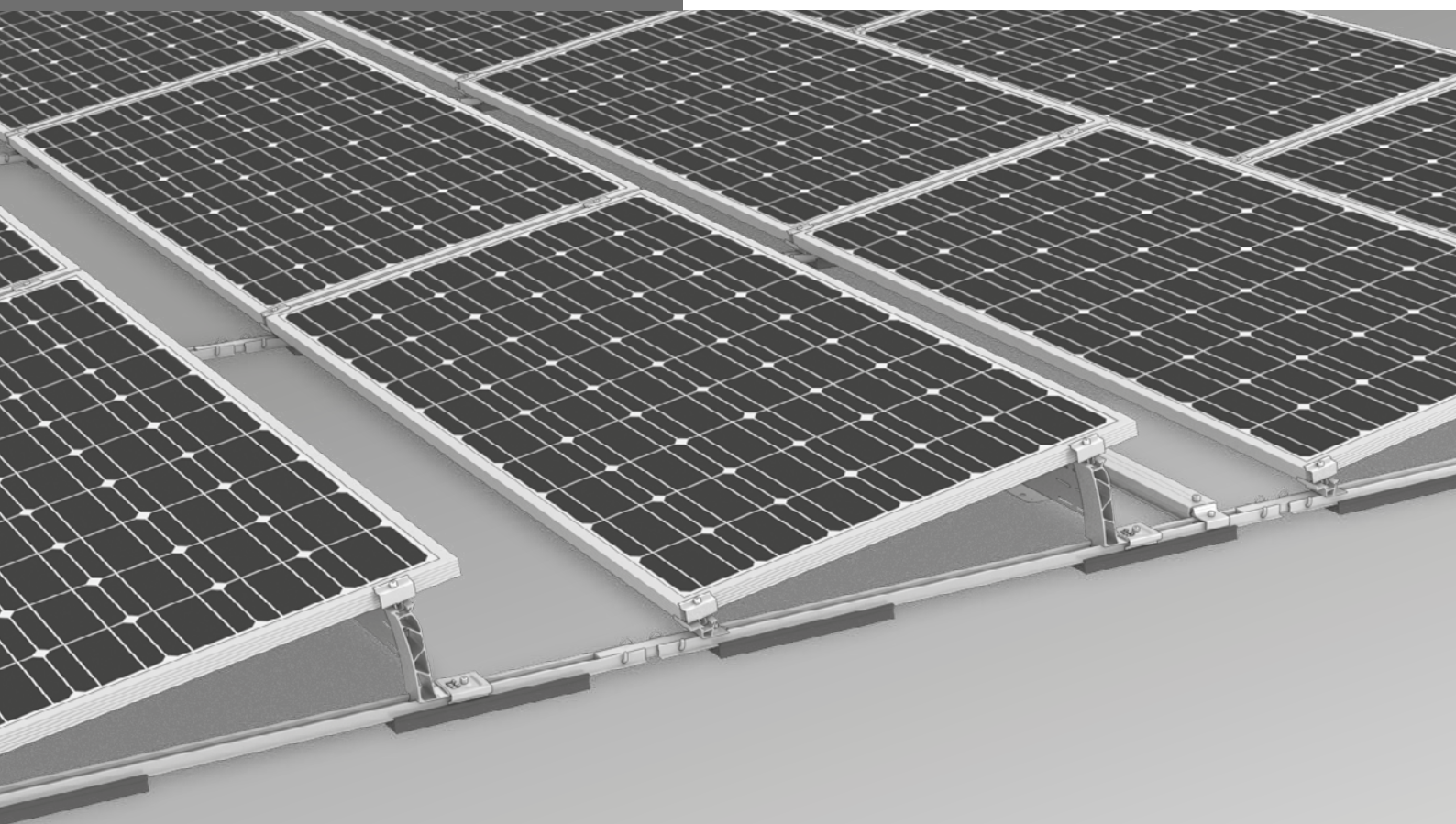

# Content

/ Tools overview	3
/ General safety information	4
/ The following guidelines apply	5
· Roof requirements	5
· Static requirements	5
· Important mounting instructions	5
/ Components	6
· Base components	6
· Ballast	8
· Edge bracing	9
· Fixed connection to the roof	10
/ Assembly	11
· Installation of module field and thermal separations	11
· Ballast options	15
· Module assembly	16
· Assembly Windbreaker	17
/ Optionale assembly steps	18
· Fixed connection with Dome FixPro Set using Solmont mounting base	18
· Edge bracing	19
· Cable management	20
· Equipotential bonding with TerraGrif	20
/ Notes	21

## Quality tested – several certifications

K2 Systems stands for secure connections, highest quality and precision. Our customers and business partners have known that for a long time. Independent institutes have tested, confirmed and certified our capabilities and components.

Please find our quality and product certificates under:  
[k2-systems.com/en/technical-information](https://k2-systems.com/en/technical-information)

# Tools overview

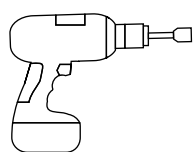

6 mm



6 mm

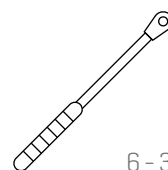

6 - 30 Nm  
[4.5 - 22.2 lb-ft]



6 mm

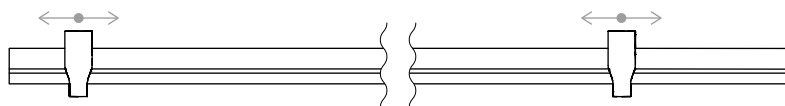

**Dome Speed Spacer** · 2003253  
Distance template for module lengths

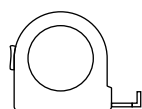

≥ 3.0 m



≥ 6.0 m

# General safety information

Please note that our general mounting instructions must be followed at all times and can be viewed online at [k2-systems.com/en/technical-information](http://k2-systems.com/en/technical-information)

- The equipment may only be installed and operated by qualified and adequately trained installers.
- Prior to installation, ensure that the product complies with on-site static loading requirements. For roof-mounted systems, the roof load-bearing capacity must always be checked.
- National and local building regulations and environmental requirements must be adhered to.
- Compliance with health and safety regulations, accident prevention guidelines and applicable standards is required.
  - Protective equipment such as safety helmet, boots and gloves must be worn.
  - Roofing works must be in accordance with roofing regulations utilising fall protection safeguards when eaves height exceeds 3 m.
  - At least two people must be present for the duration of the installation work in order to provide rapid assistance in the event of an emergency.
- K2 mounting systems are continuously developed and improved and the installation process may thereby change at any time. Prior to installation consult our website at [www.k2-systems.com/en/technical-information](http://www.k2-systems.com/en/technical-information) for up-to-date instructions. We can send you the latest version on request.
- The assembly instructions of the module manufacturer must be adhered to.
- Equipotential bonding/grounding/earthing between individual parts is to be performed according to country specific standards, as well as national laws and regulations.
- At least one copy of the assembly instructions should be available on site throughout the duration of the installation.
- Failure to adhere to our general safety and assembly instructions and not using all system components, K2 is not liable for any resulting defects or damages. We do not accept liability for any damage resulting in the use of competitor's parts. Warranty is excluded in such cases.
- German law shall apply excluding the UN Convention on CISG. Place of venue is Stuttgart. Our General Terms of Business apply.
- If all safety instructions are adhered to and the system is correctly installed, there is a product warranty entitlement of 12 years! We strongly recommend reviewing our terms of guarantee, which can be viewed at [www.k2-systems.com/en/technical-information](http://www.k2-systems.com/en/technical-information) We will also send this information on request.
- Dismantling of the system is performed in reverse order to the assembly.
- K2 stainless steel components are available in different corrosion resistance classes. Each structure or component must be carefully checked for possible corrosion exposure.

# The following guidelines apply

The D-Dome 6 system can be installed as standard under the following conditions. Even if the system is capable of meeting higher demands through the integration of safety standards, please get in touch with your contact at K2 Systems if the specified values are exceeded.



## Roof requirements

- This system can be installed on all common flat roofs with a pressure-resistant base and a roof pitch of  $\leq 3^\circ$  without fixed connection. Up to  $10^\circ$  roof pitch is possible with the Dome FixPro Set and a corresponding mechanical fastening on the roof.
- The roof surface must be clean and dry. Roof irregularities must be corrected or removed where appropriate.
- The coefficient of friction of the roof must be determined on-site. See video [k2-systems.com/en/friction-coefficient](https://k2-systems.com/en/friction-coefficient)

an inspection find damage or plastic deformation (such as in the module clamp area) the components must be replaced.

### Modules and clamping

- Tightening torque of 14 Nm for all module clamps.
- Adhere to module manufacturer recommendations for clamping area and module installation [see module manufacturer instructions]. Check whether manufacturer approval is available for clamping on the short module side. See [k2-systems.com/en/approved-modules-dome-6](https://k2-systems.com/en/approved-modules-dome-6)



## Static requirements

- It is essential to check that the roof structure has sufficient residual load capacity and that the pressure capacity of the roof insulation (where present) is not exceeded.
- Suitable for framed modules with a frame height 30 - 50 mm
- Permissible module dimensions: length 1448 - 2150 mm, width 950 - 1060 mm

### General information

- External influences that act on this system are only reflected in the design of the ballast to a limited degree. For instance, unevenness, thermal elongation, moss, water accumulation and ageing of the sheeting cannot be considered, although these factors might also precipitate system displacement under certain circumstances. We recommend you check whether the system requires additional mechanical attachment, as the impact of these influences may be greater on slanted roofs.
- It is important to ensure that the rain water flow is not hindered.
- Because of the different orientation of the solar modules, the string and inverter connection must be appropriately observed. It is recommended that the inverters and strings are connected separately.
- On-site general standards and regulations for lightning protection must be observed and consultation with a specialist to create a lightning protection concept is recommended [use lightning protection clamp if necessary].



## Important mounting instructions

### Mounting system

- The inclination of the S-Dome 6 system is  $10^\circ$ .
- A minimum distance to the roof edge of 600 mm must be observed.
- The compatibility of the roof covering and the Mat S support pad must be checked.
- An array must consist of at least two elevations must for this mounting system to be properly utilized.
- Ensure a thermal separation (distance between module blocks) after a maximum of 15 m in the module row direction and in the direction of the base rail.
- In the event of exceptional circumstances (such as storms, heavy rain, earthquakes, etc.), the system should be checked by a specialist. Should

# Components

Base components

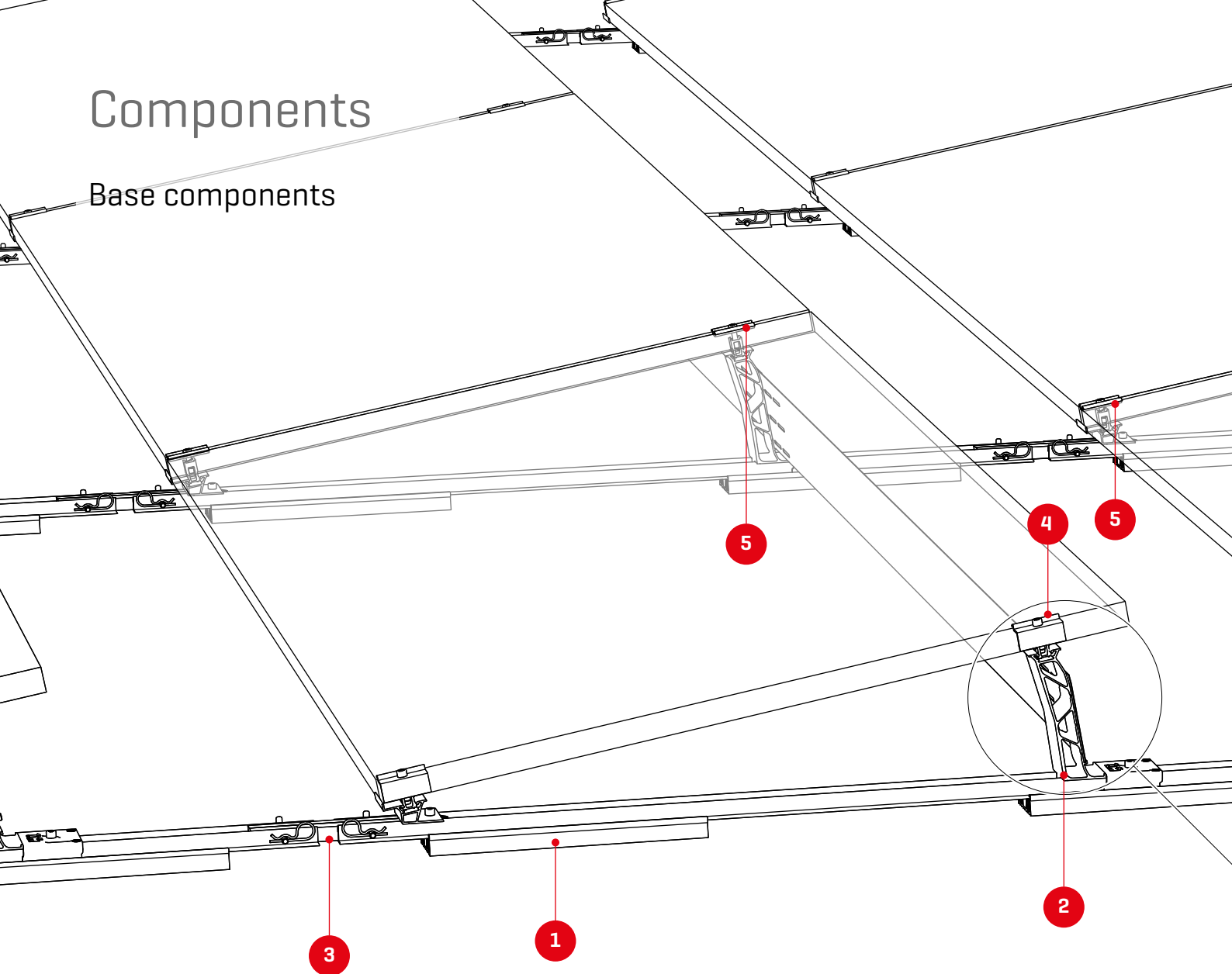

- 1** 2003247  
**S-Dome 6.10 Base Set**

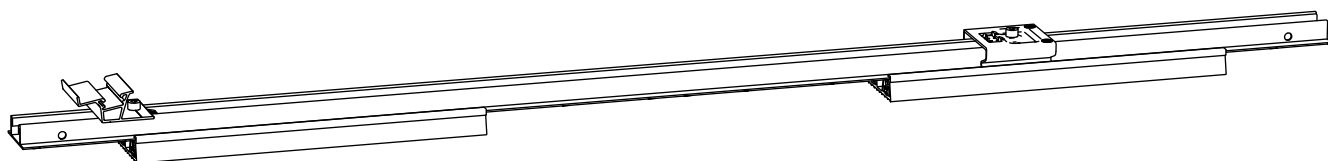

- 2** 2003248  
**Dome 6.10 Peak**

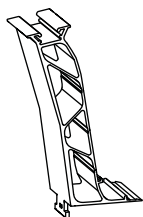

- 3** 2003251  
**Dome 6 Connector Set**

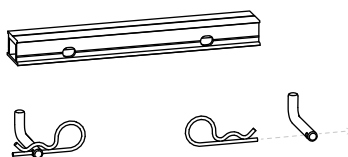

- 4** **5** 2002559 / 2002558  
**MiniClamp EC / MC**

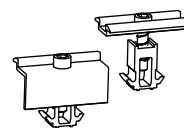

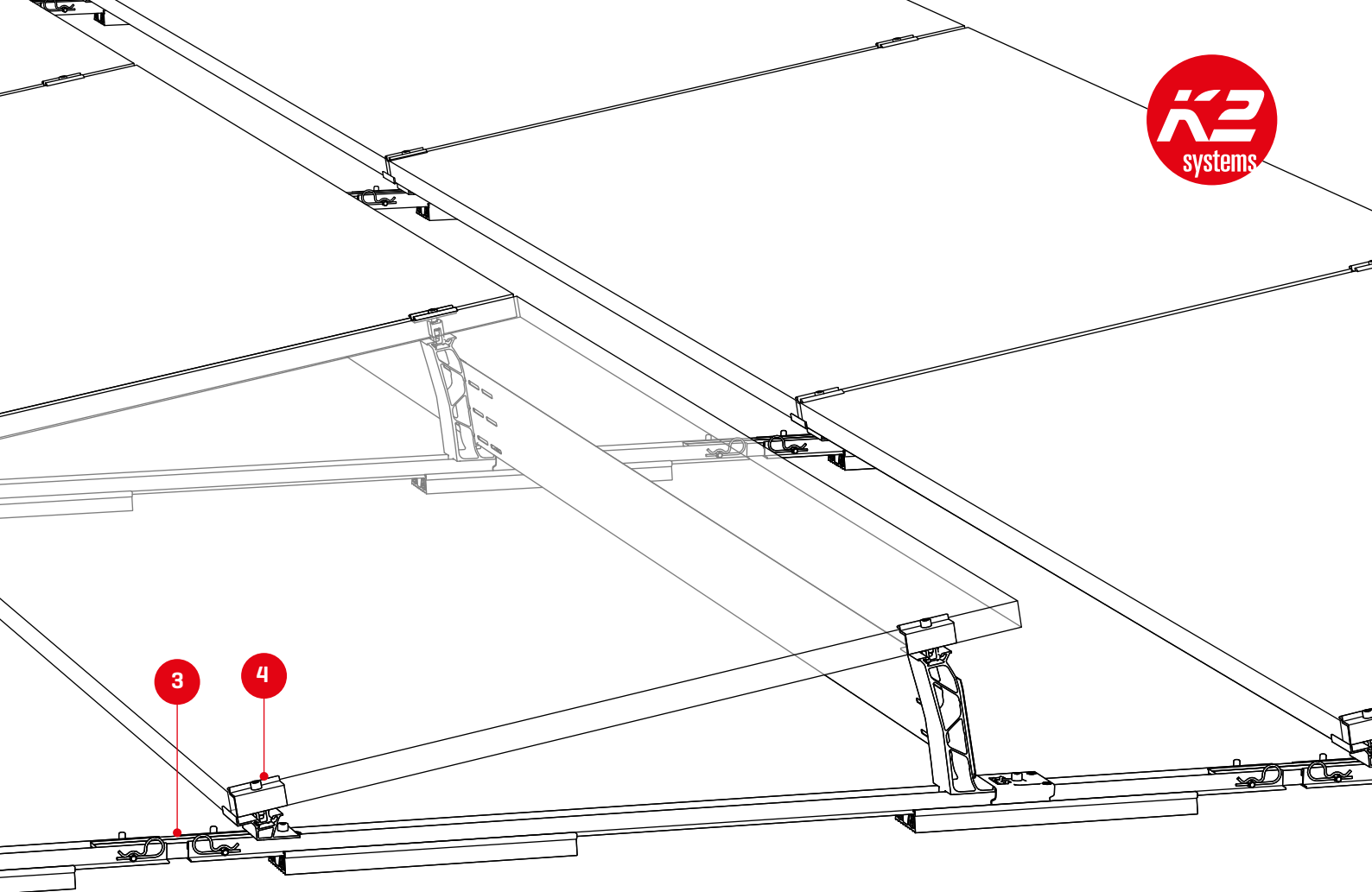

3

4

6

7

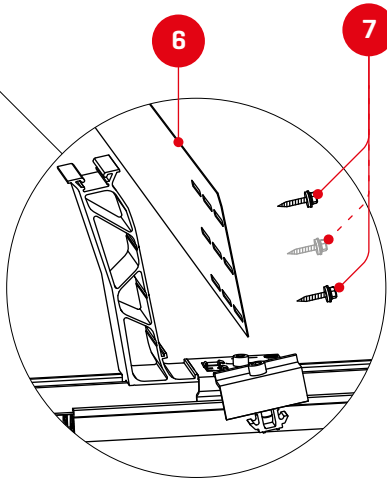

6

2003249 / 2003250  
S-Dome 6.10 Windbreaker  
60- / 72-cells

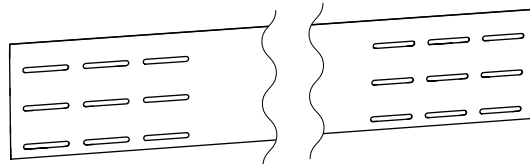

7

1005207  
Thread-forming tapping  
screw with sealing



## Dome 6 distance template

2003253  
Dome Speed Spacer

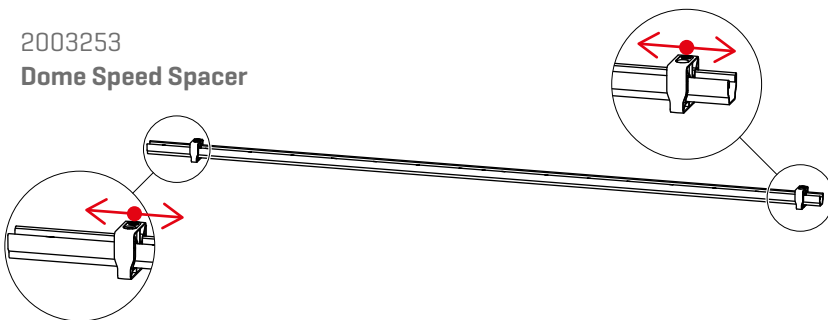

1

2

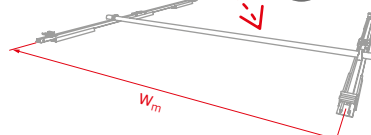
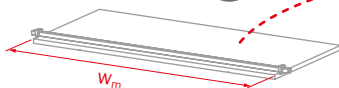

## Optional

2002870  
Cable-Manager

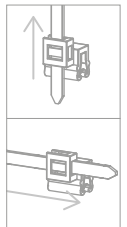
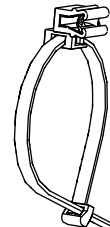

2002649  
TerraGrif K2MI



# Components

## Ballast

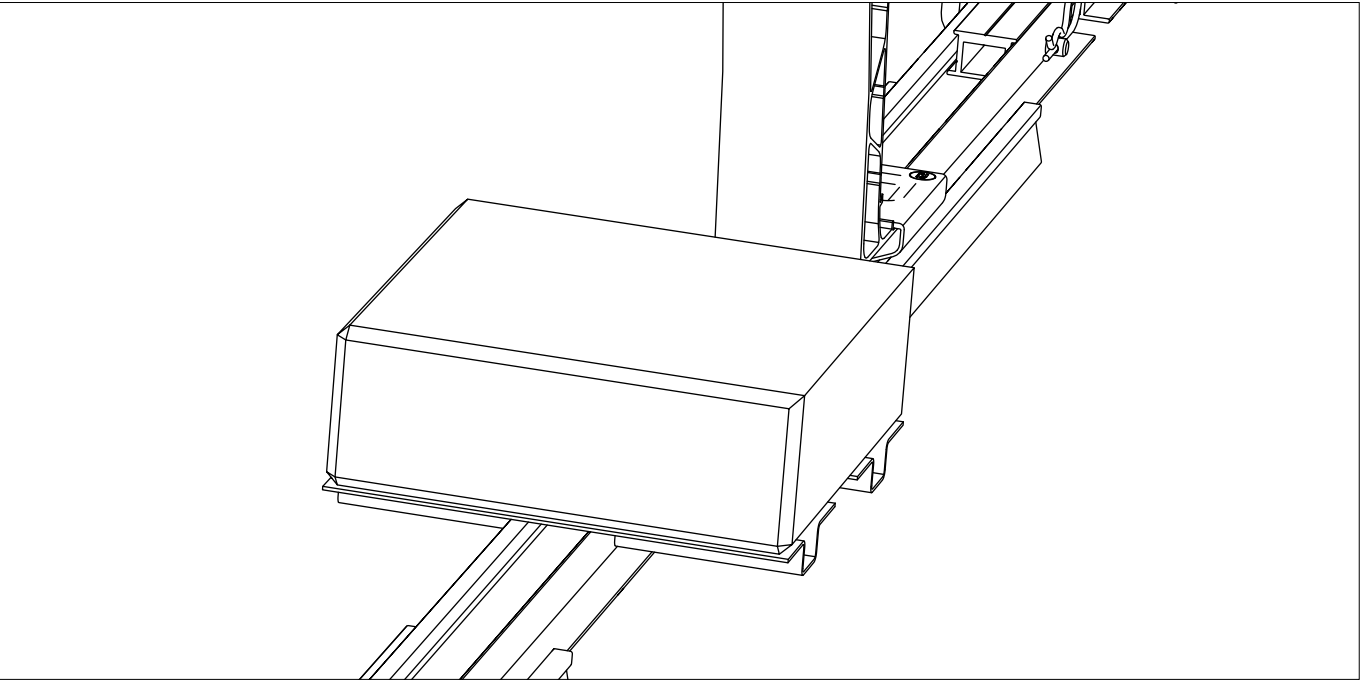

2002300  
SpeedPorter

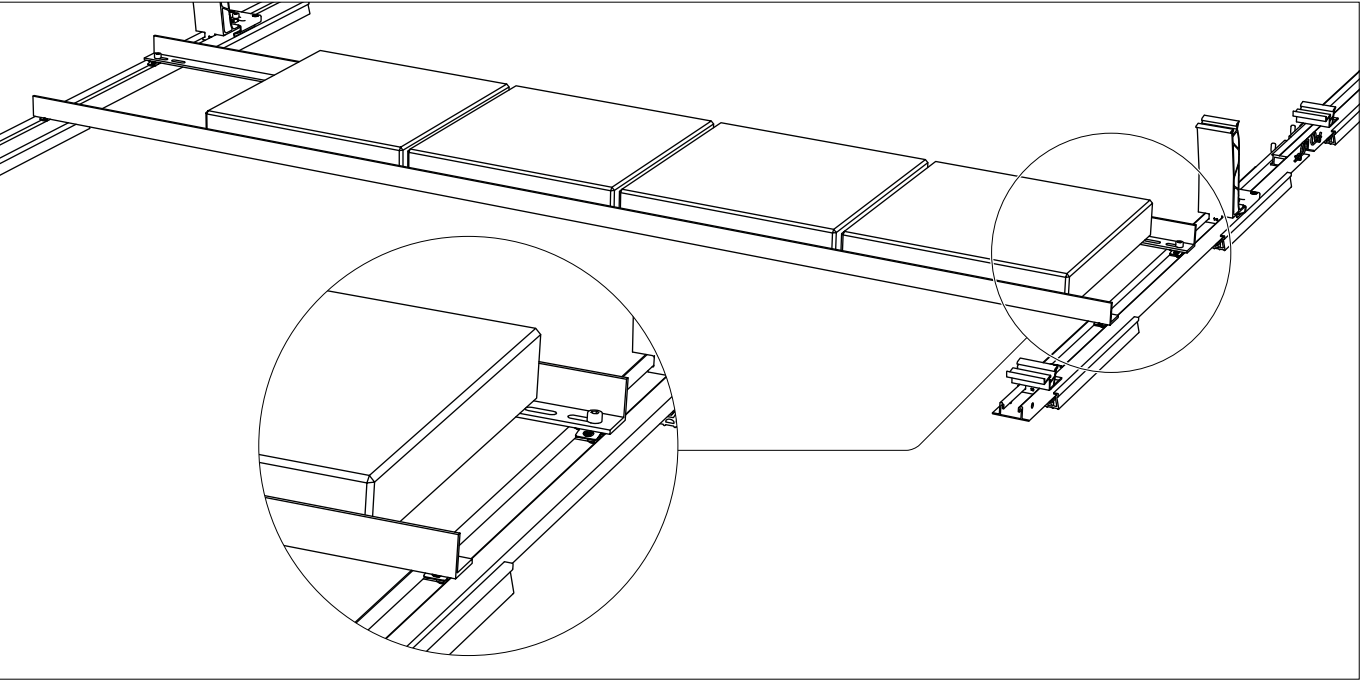
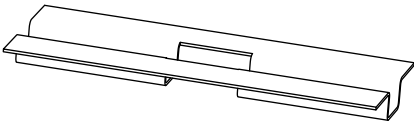

2003150/2003151  
Porter

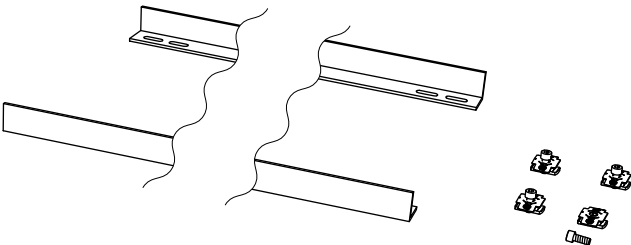

1001643 + 2001729  
MK2 Slot nut with clip +  
Allen bolt M8×20



## Edge bracing

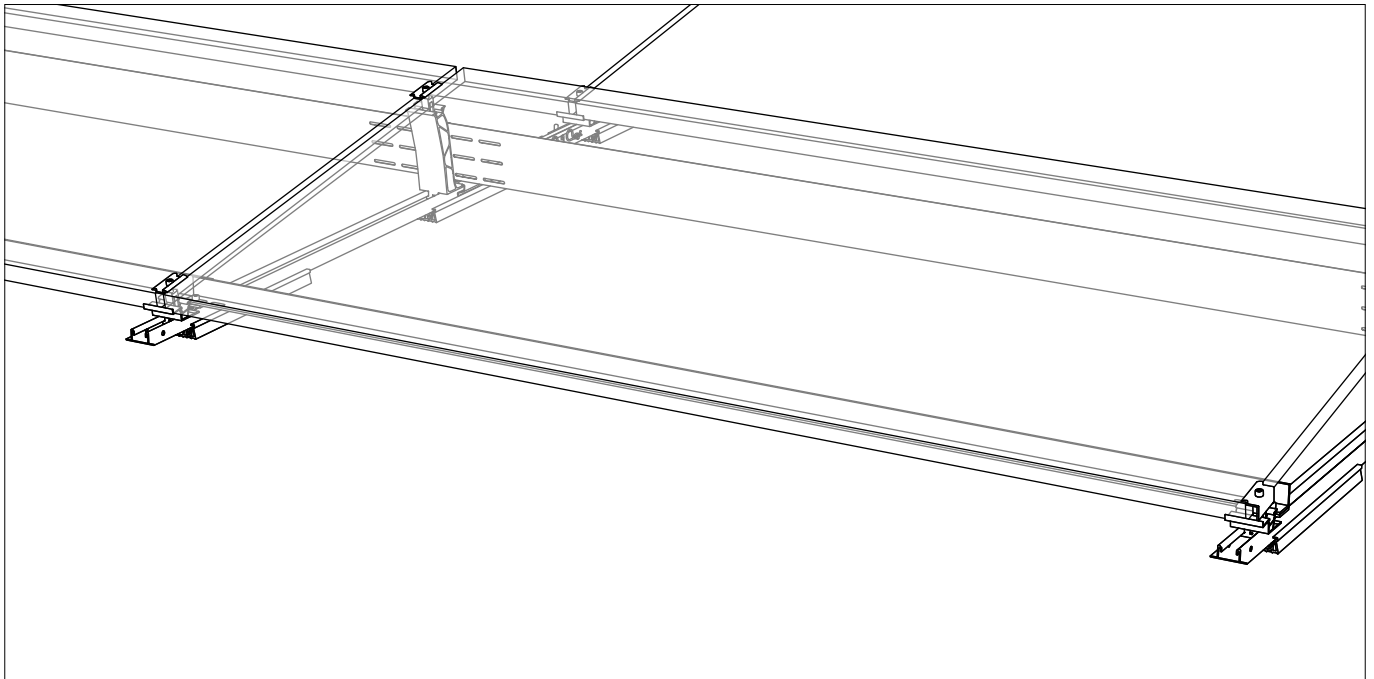

2003150 / 2003151  
**Porter**

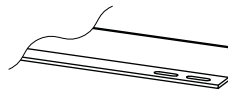

1001643 + 2001729  
**MK2 Slot nut with clip +  
Allen bolt M8x20**

## Fixed connection to the roof

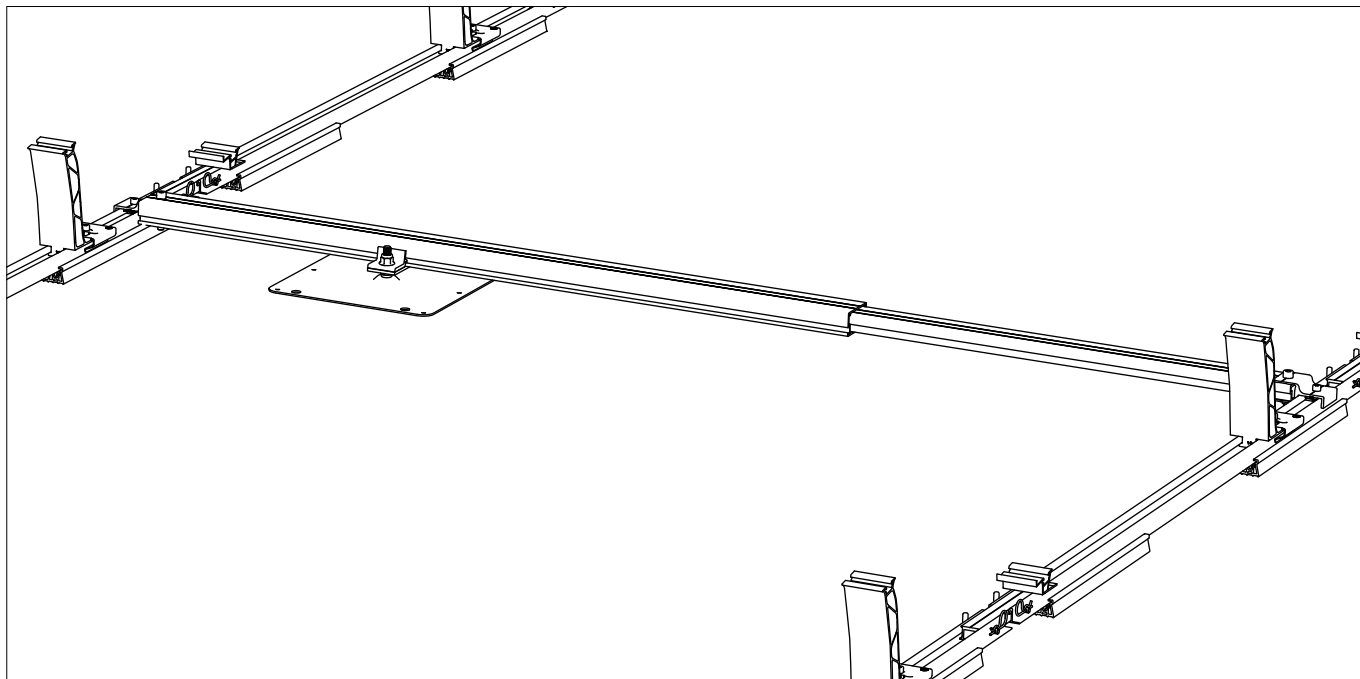

**1** 2003211  
**Dome FixPro Set**

**2** 2002546 / 2002547  
**Adapter plate M10/12**

**3** 2003146 / 2003147  
**Climber M10/12**

**4** Other fastening elements [e.g. screws and nuts] for fixing to the fastener must be provided by the customer.

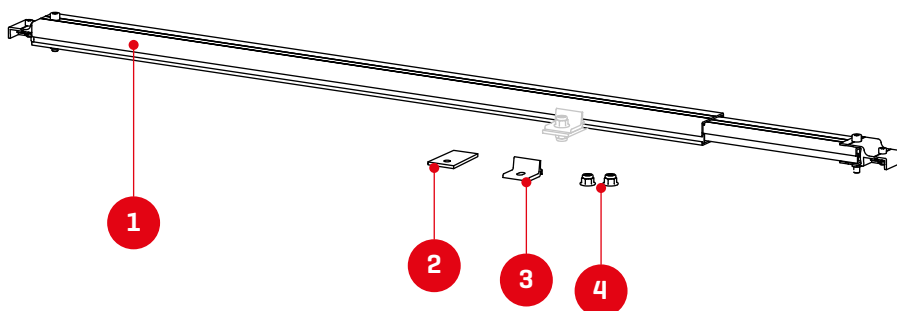

## Installation of module field and thermal separations

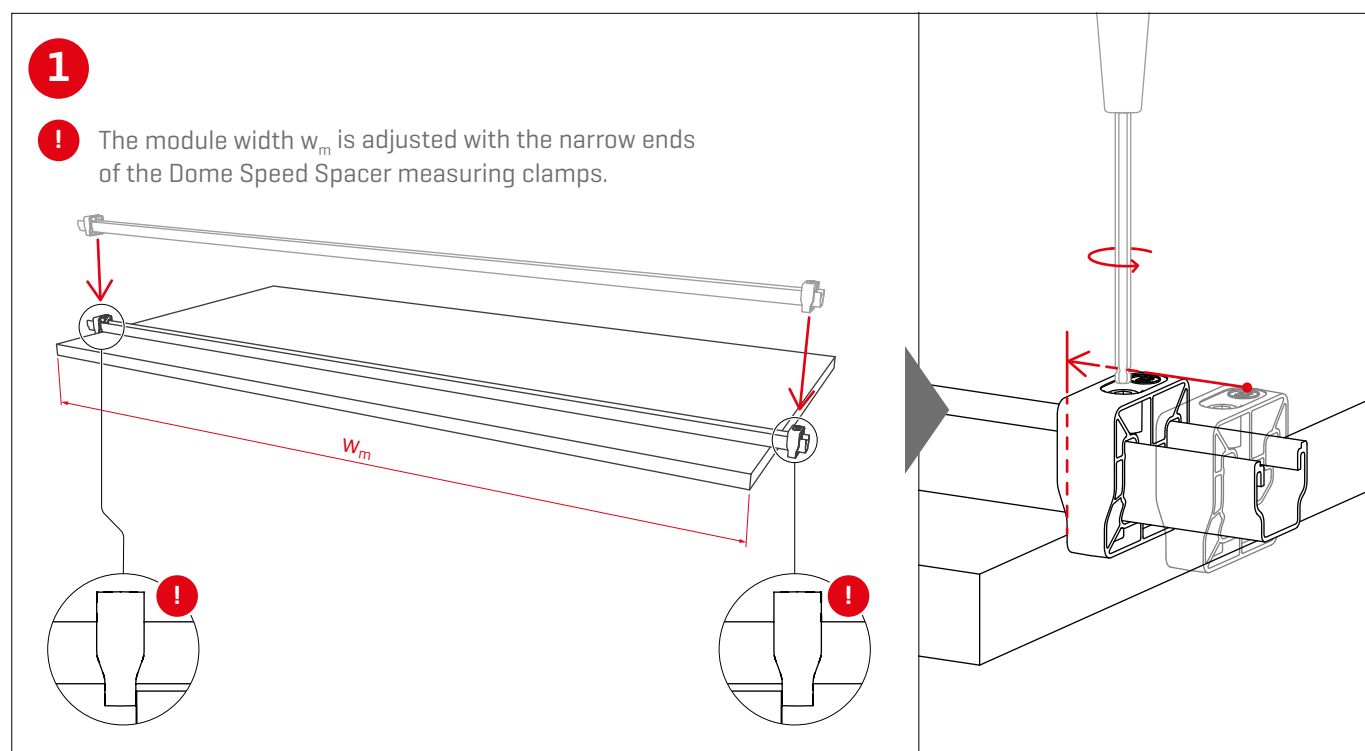
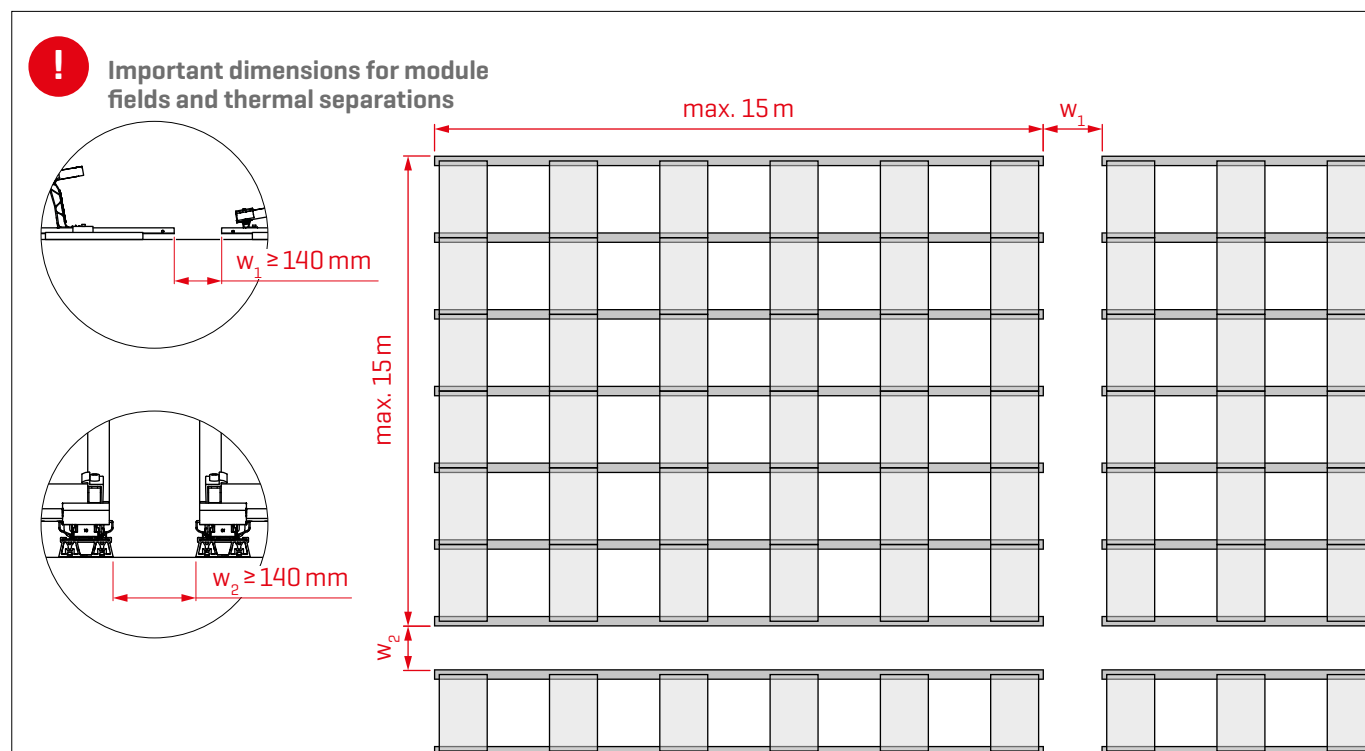

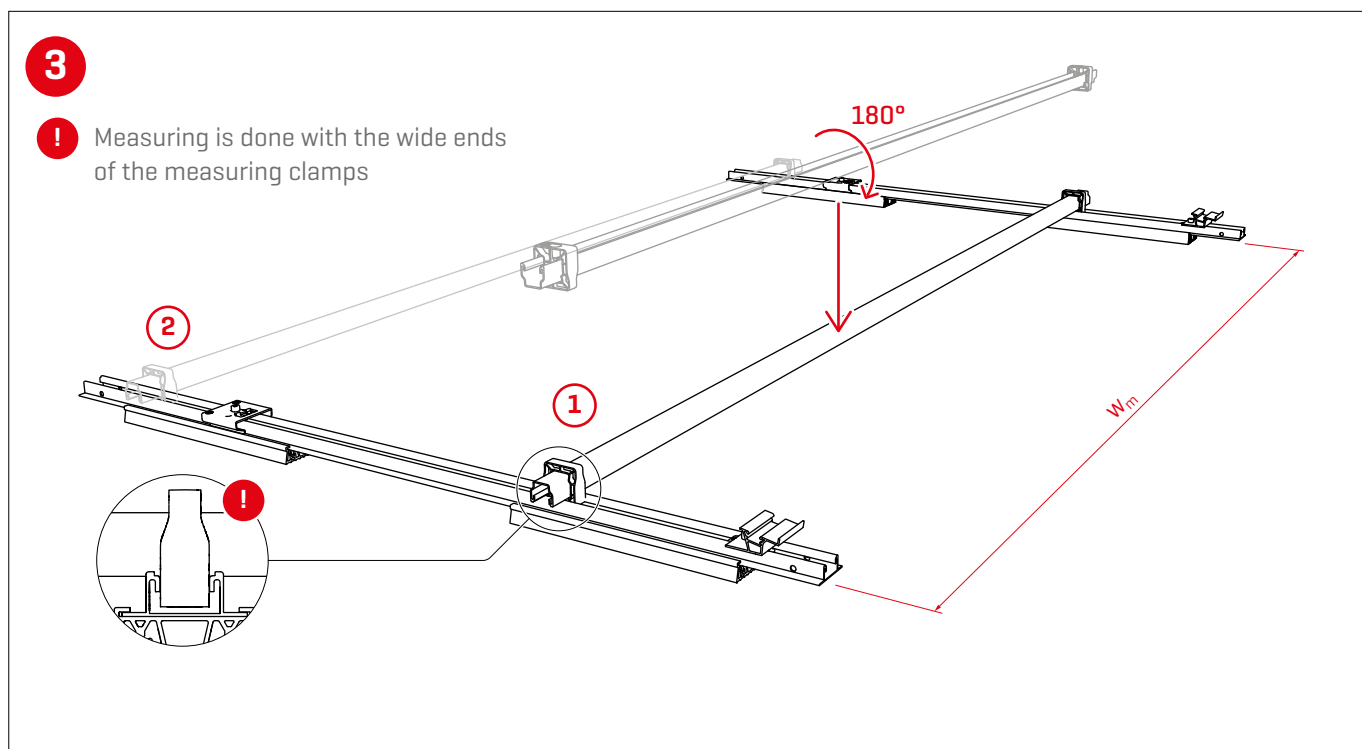
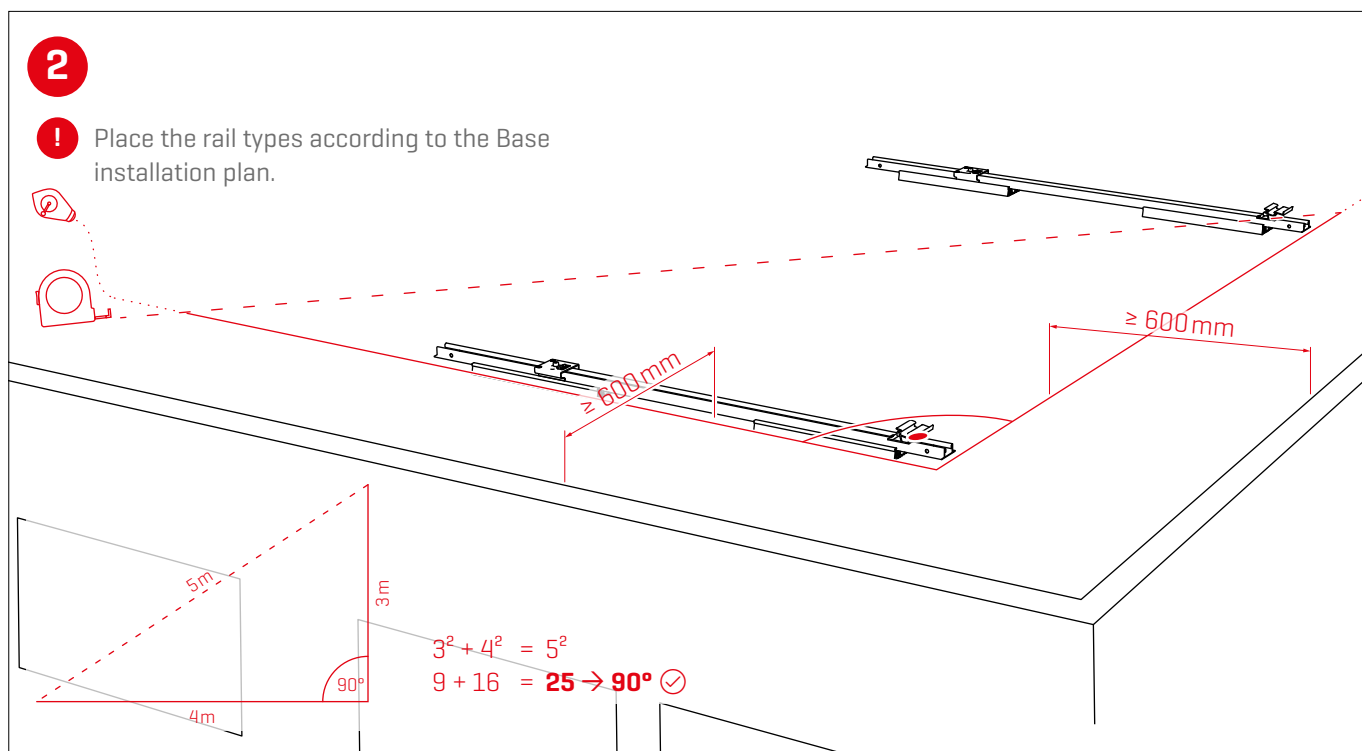

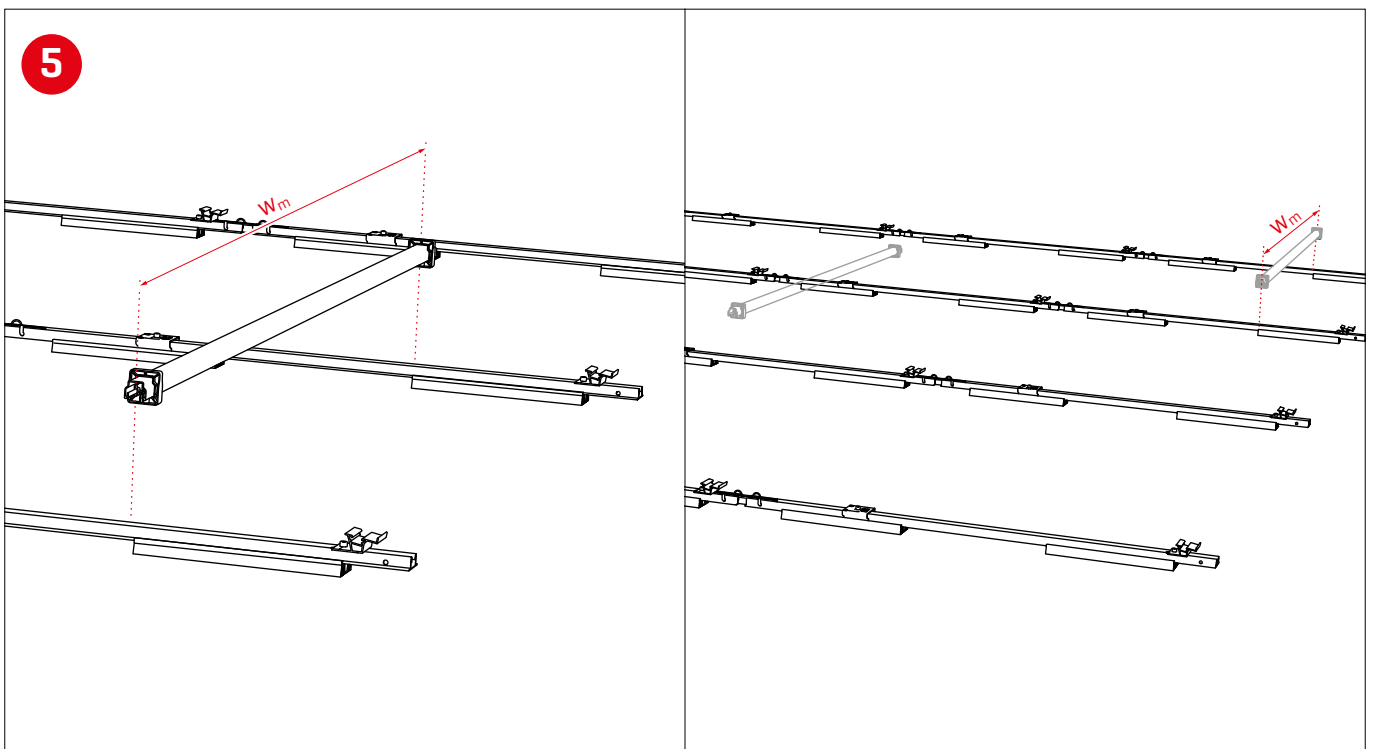
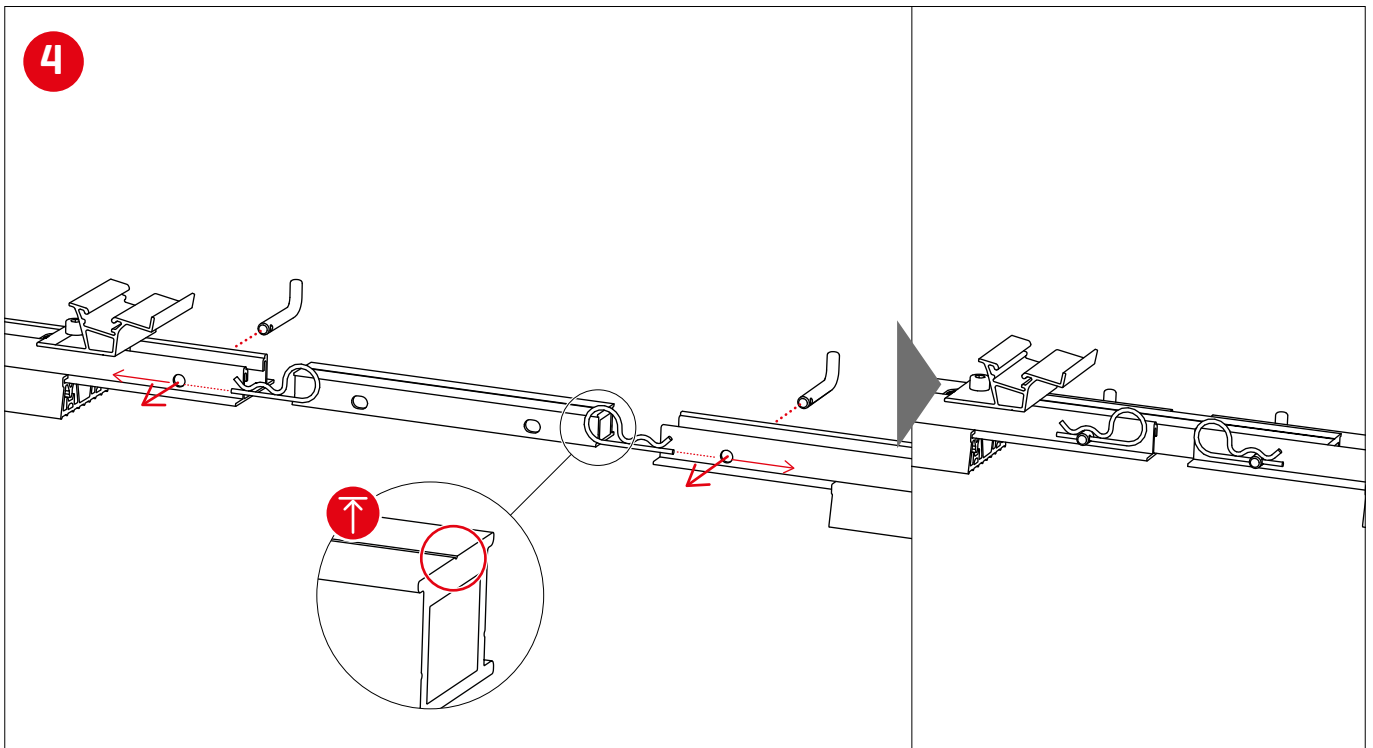

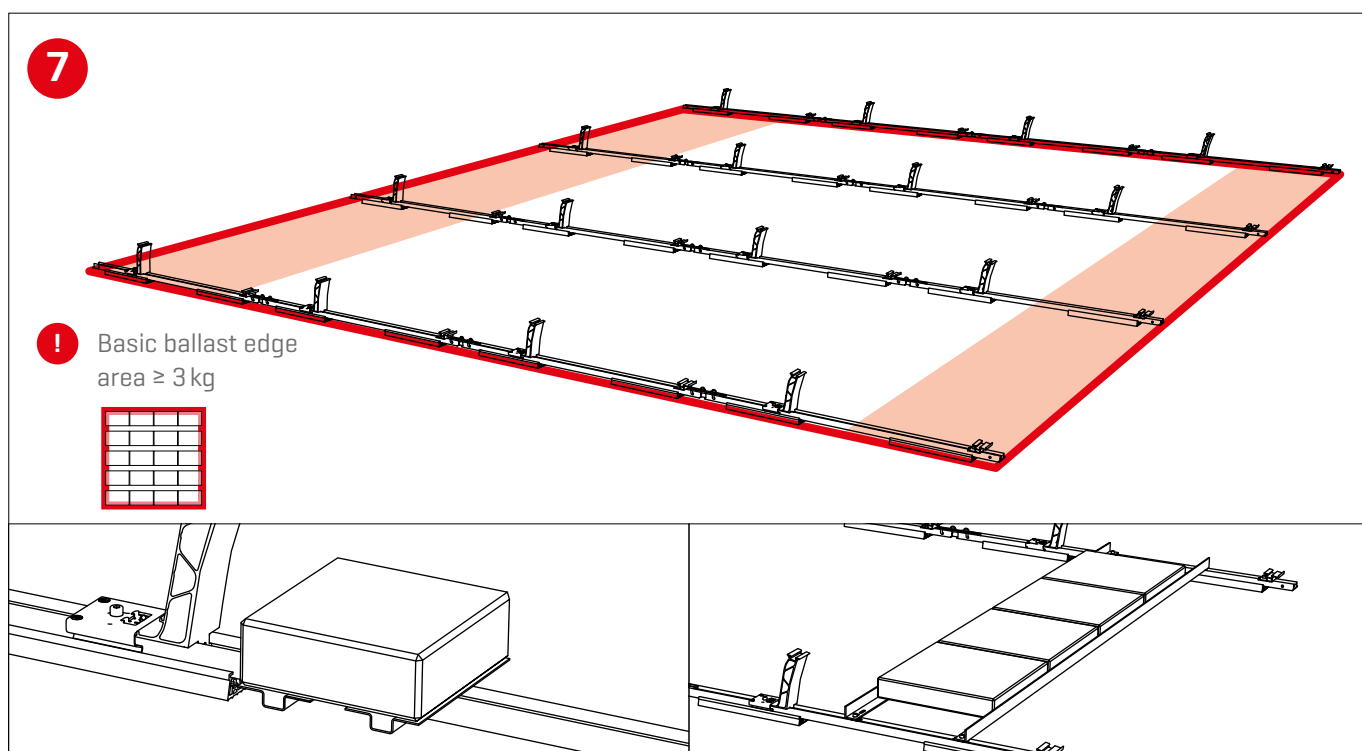
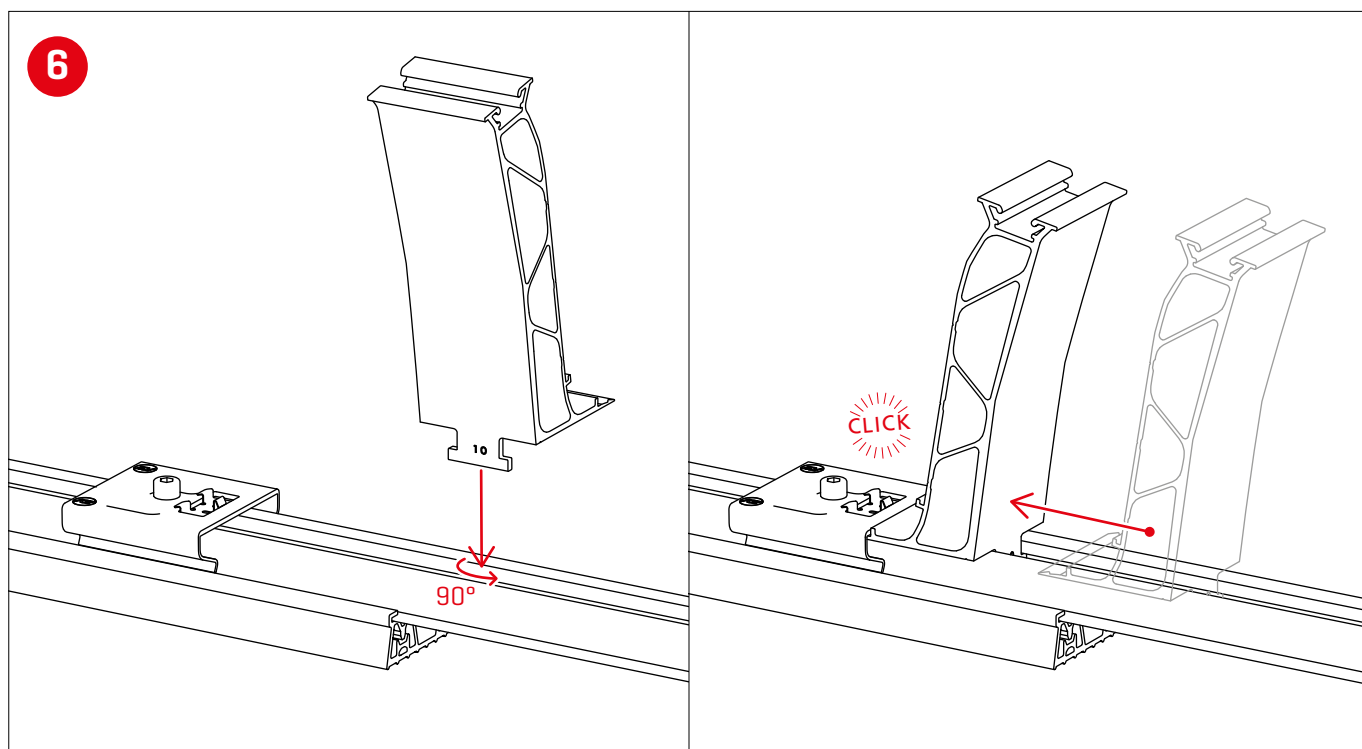

## Ballast options

Ballast data: See Base ballast plan!

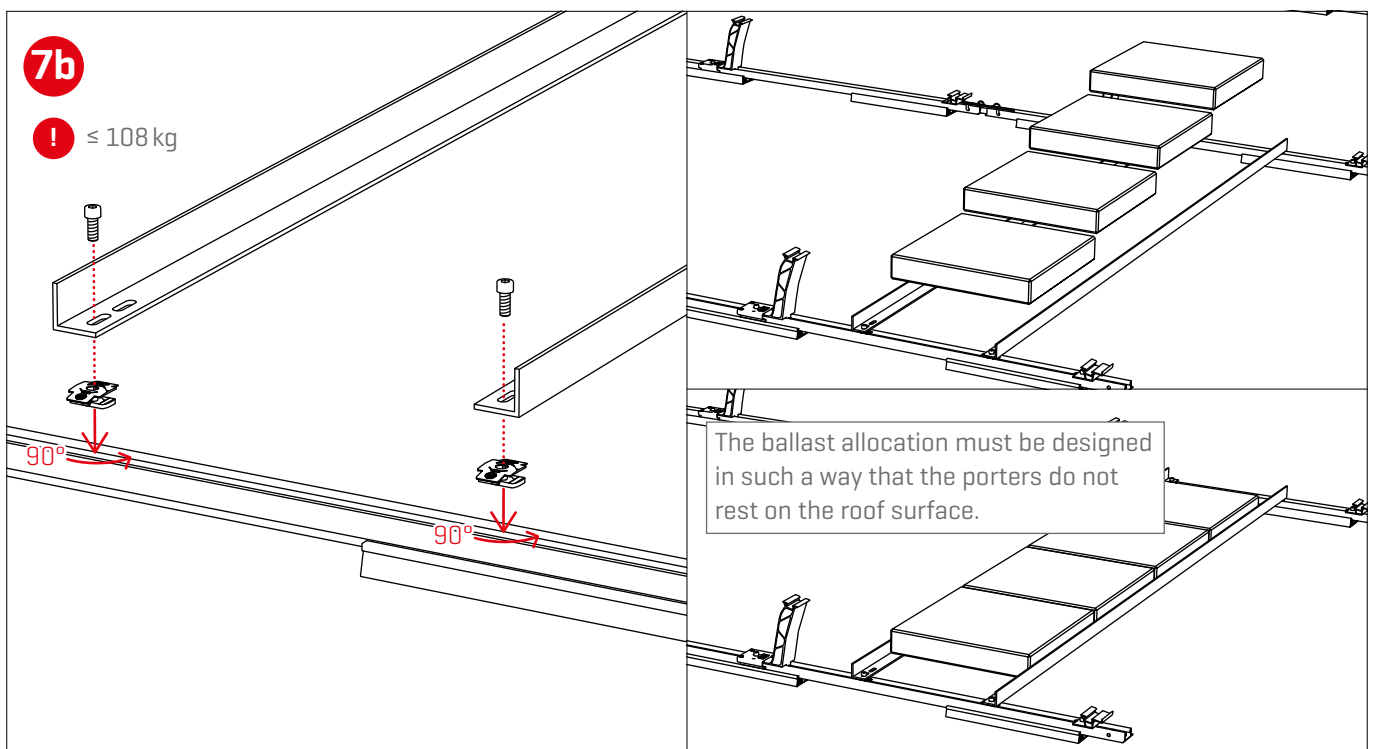
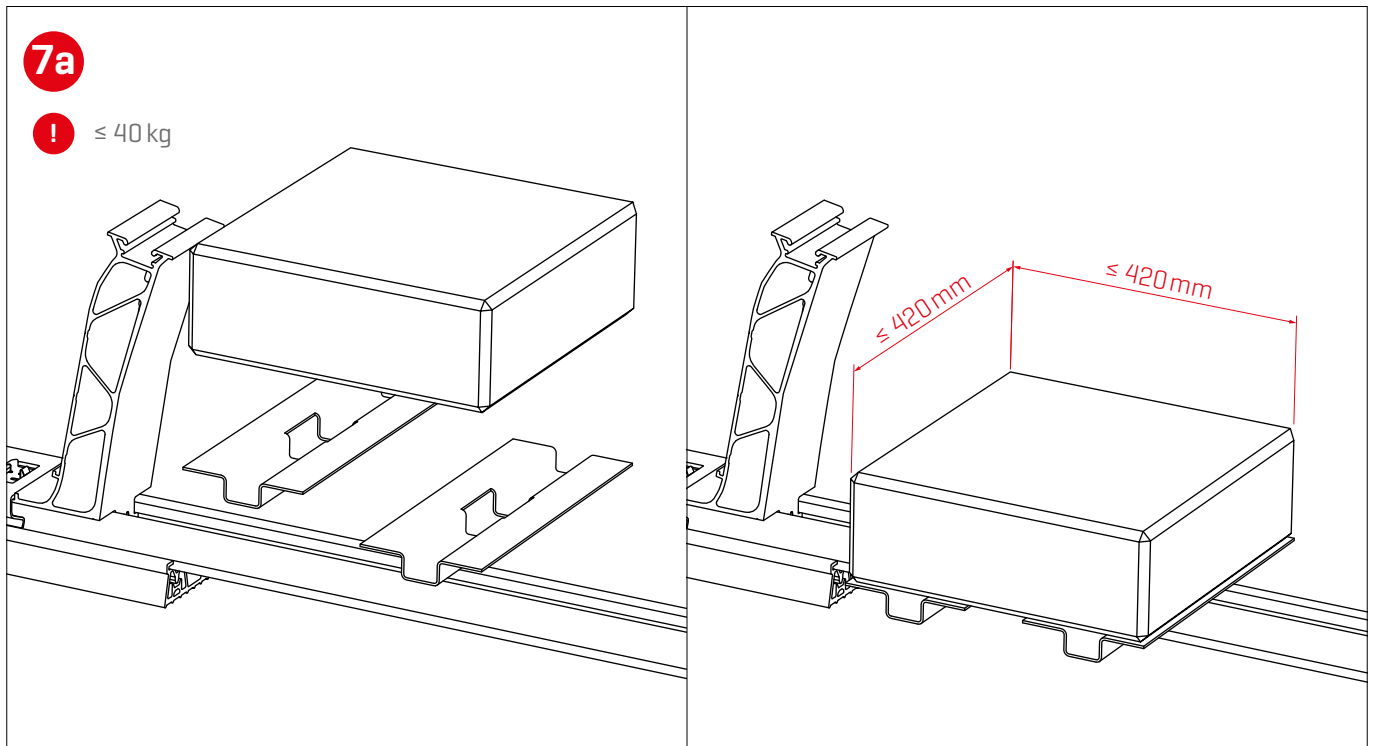

# Module assembly

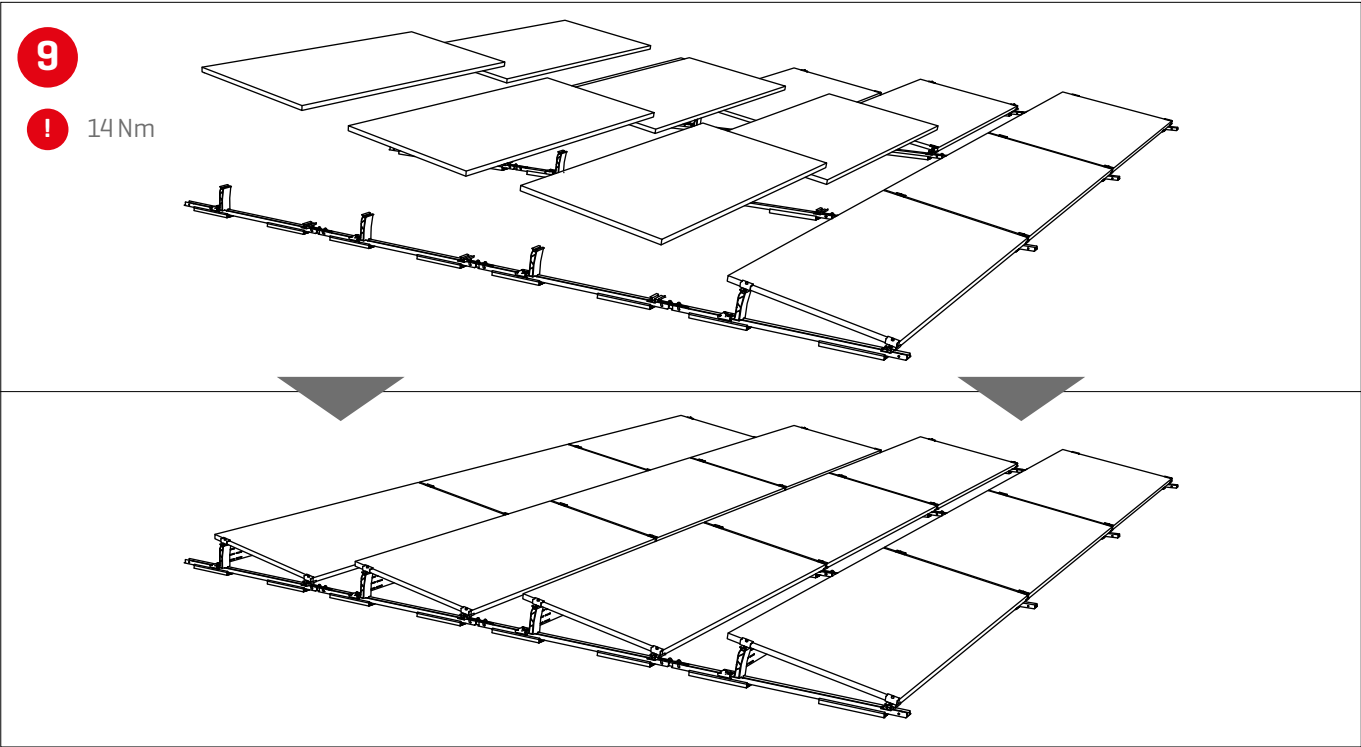
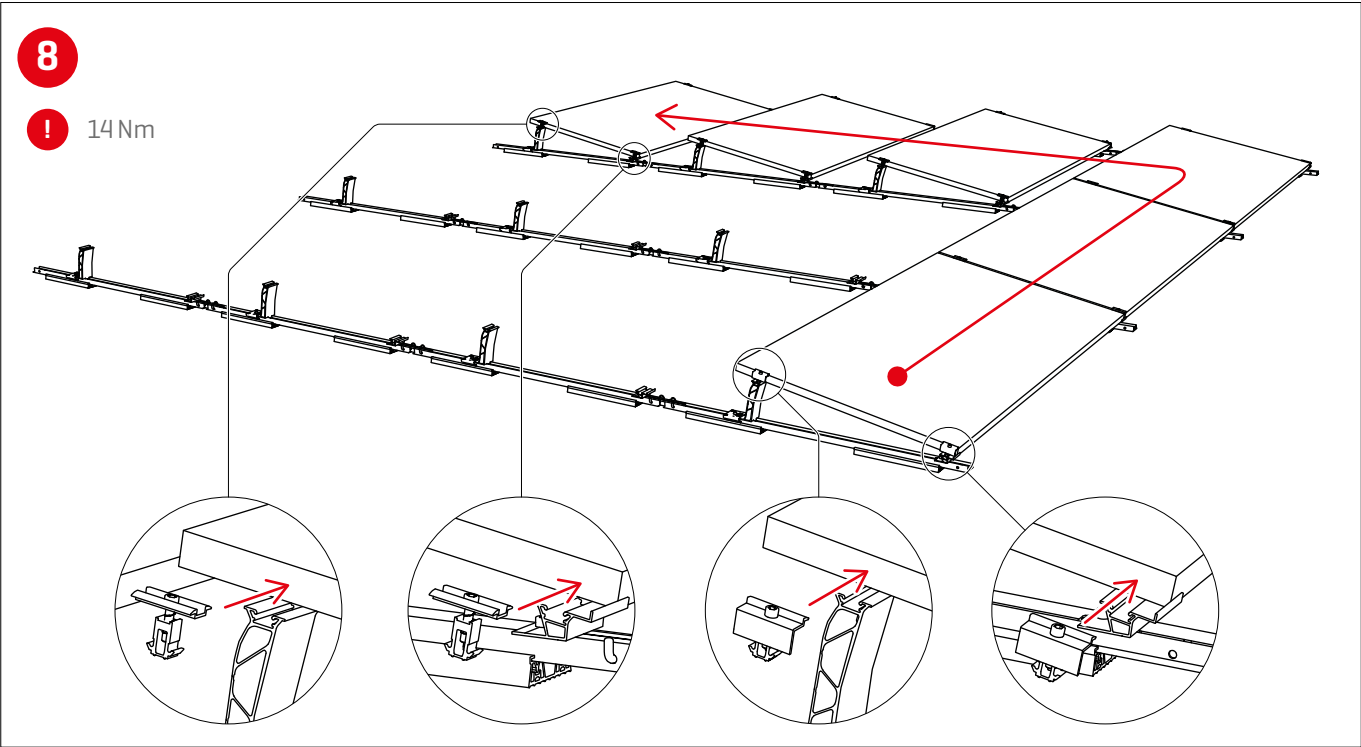



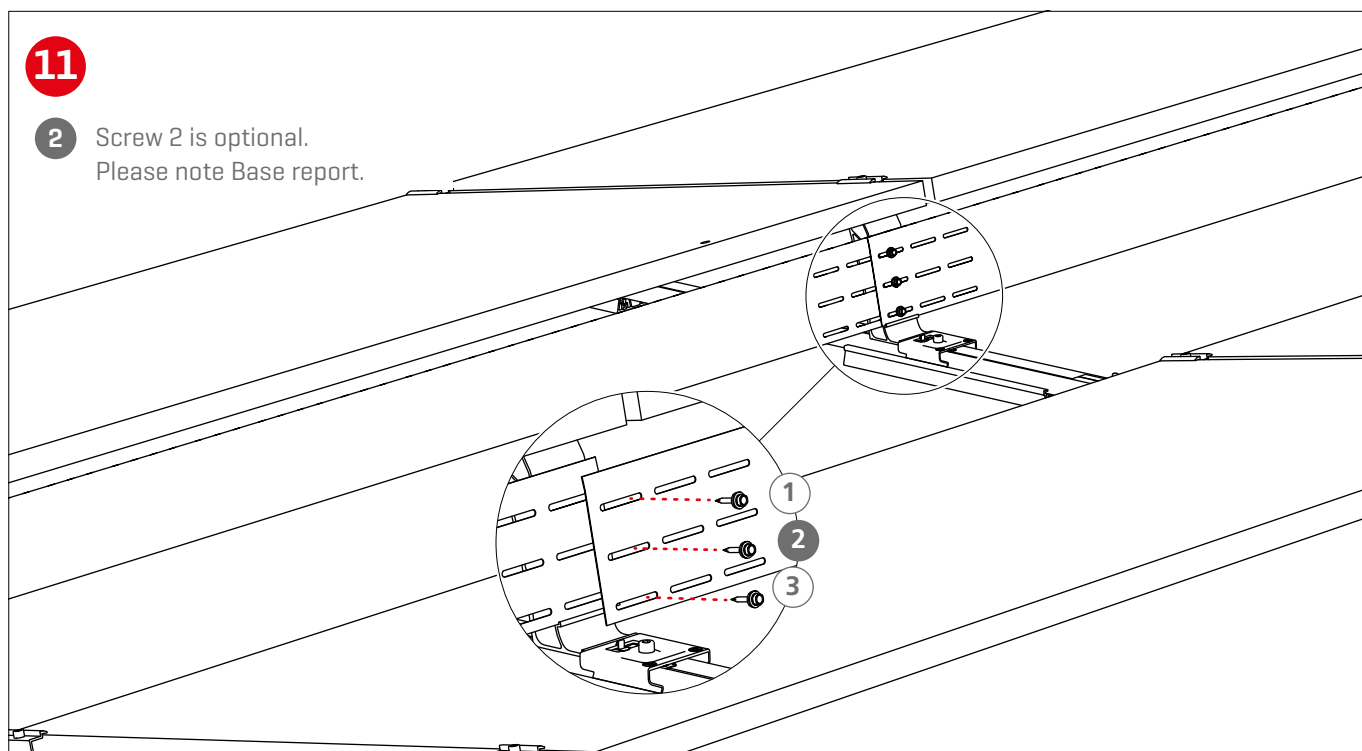
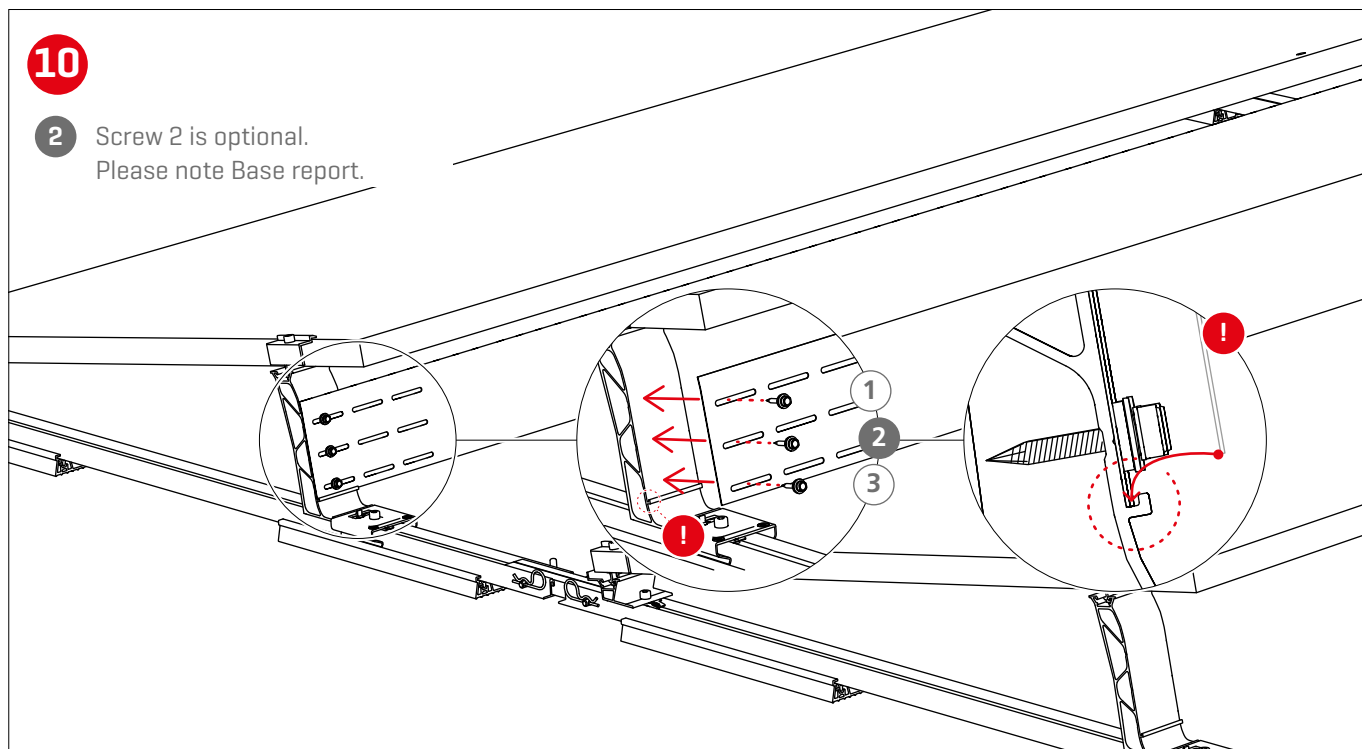

# Optionale assembly steps

## Fixed connection with Dome FixPro Set using Solmont mounting base

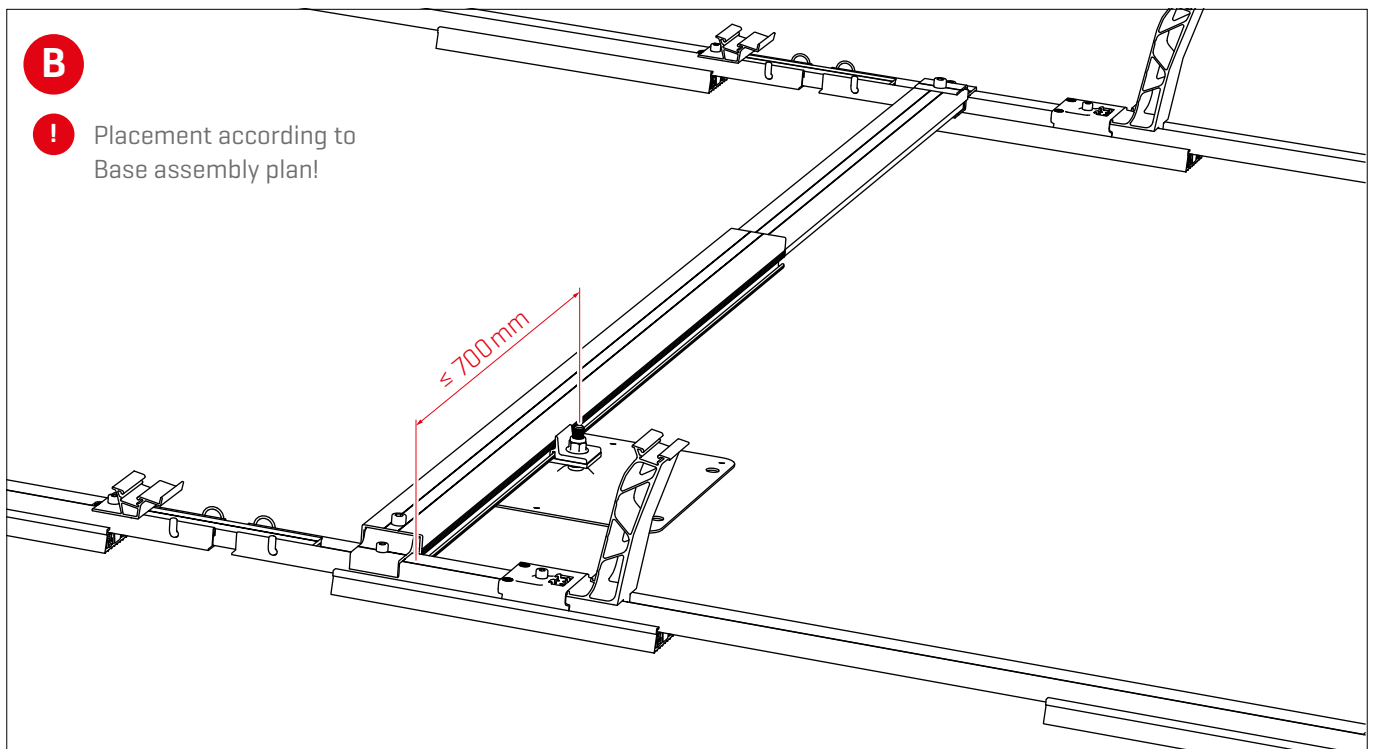
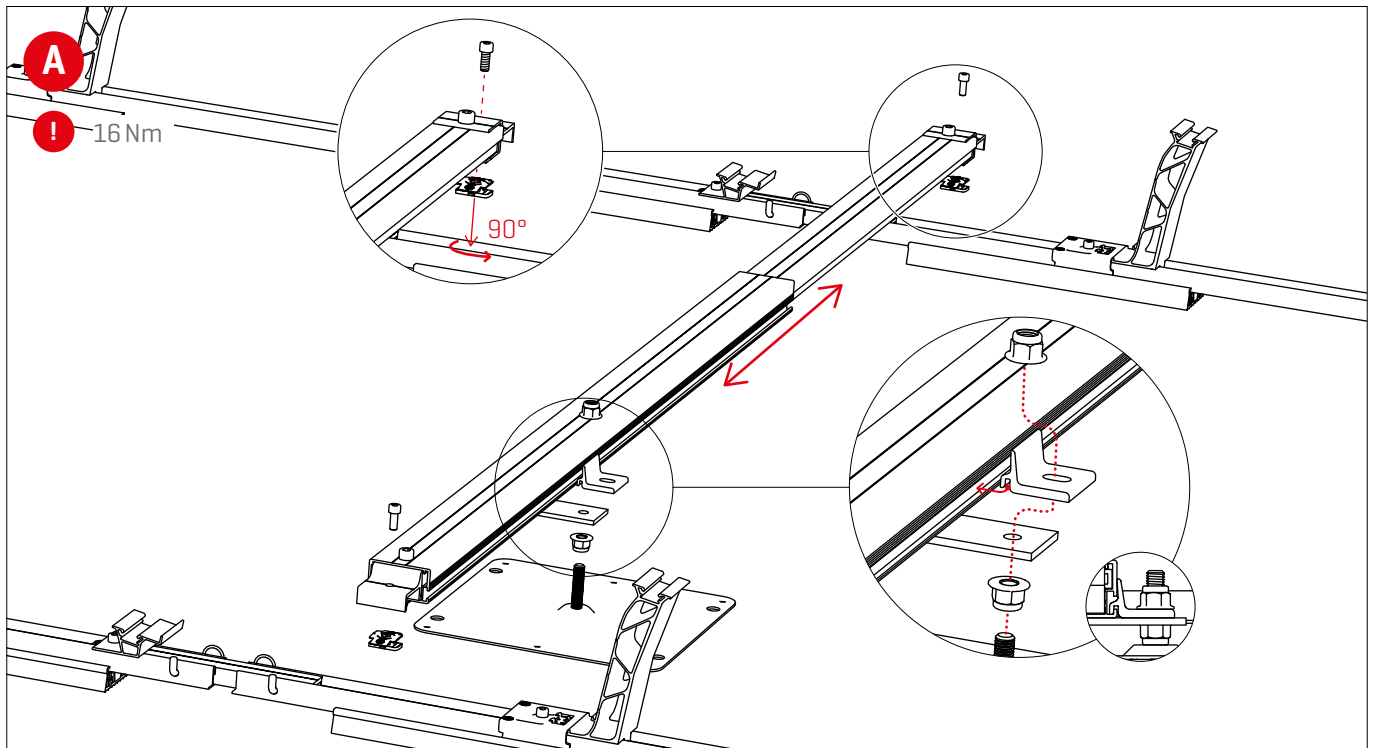

## Edge bracing

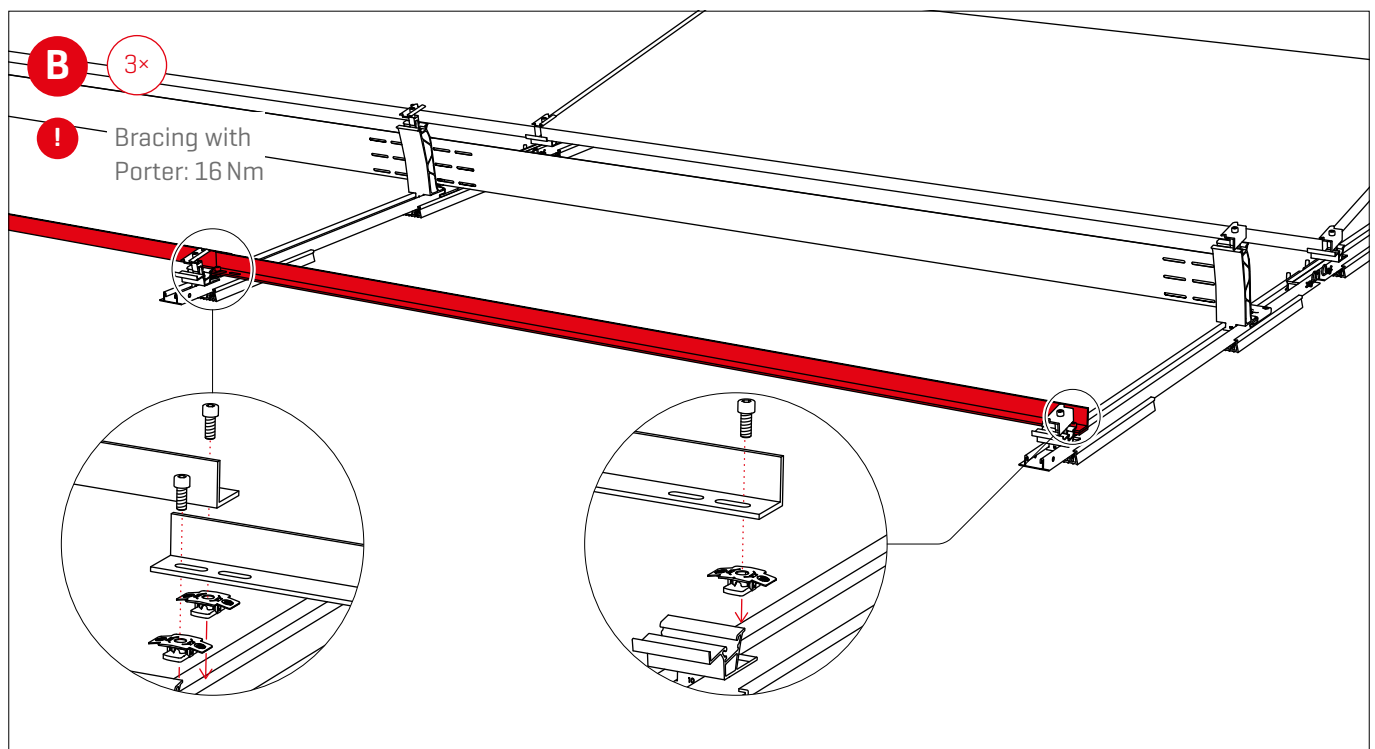
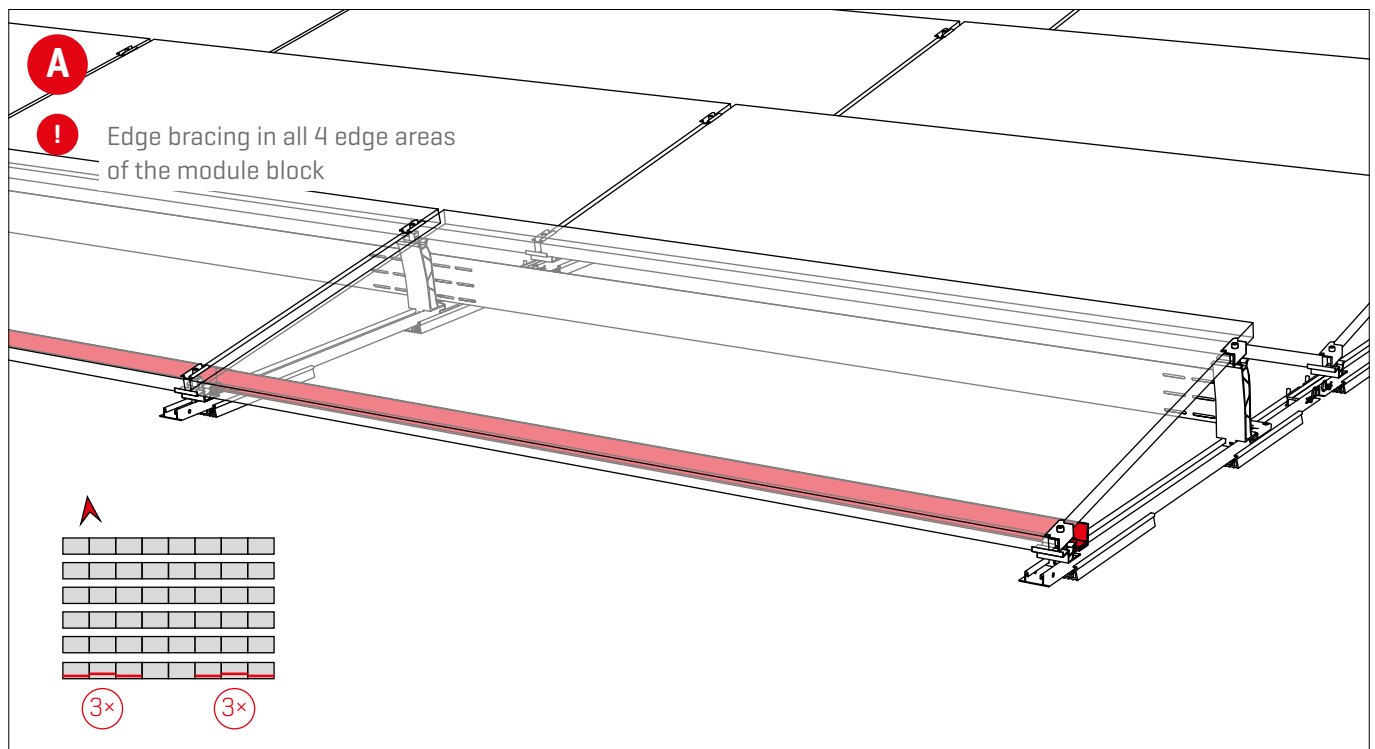

## Cable management

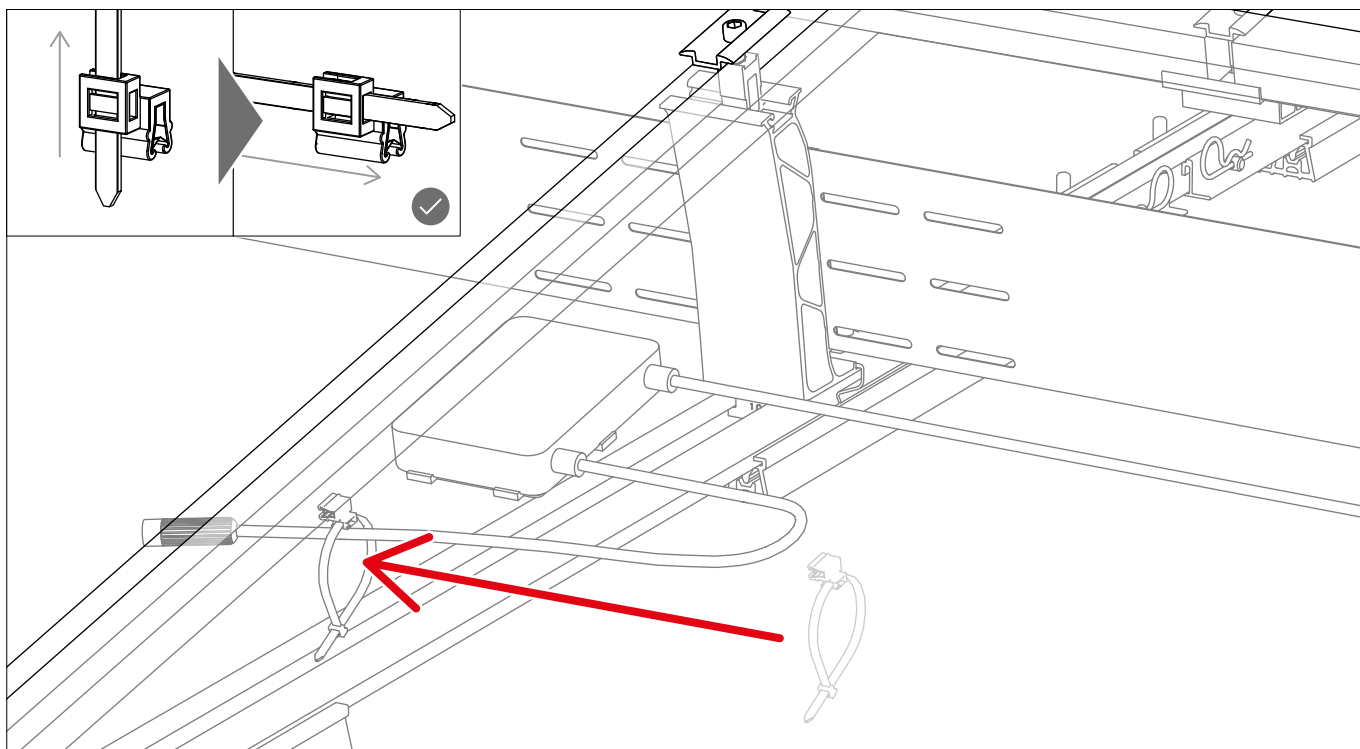

## Equipotential bonding with TerraGrif

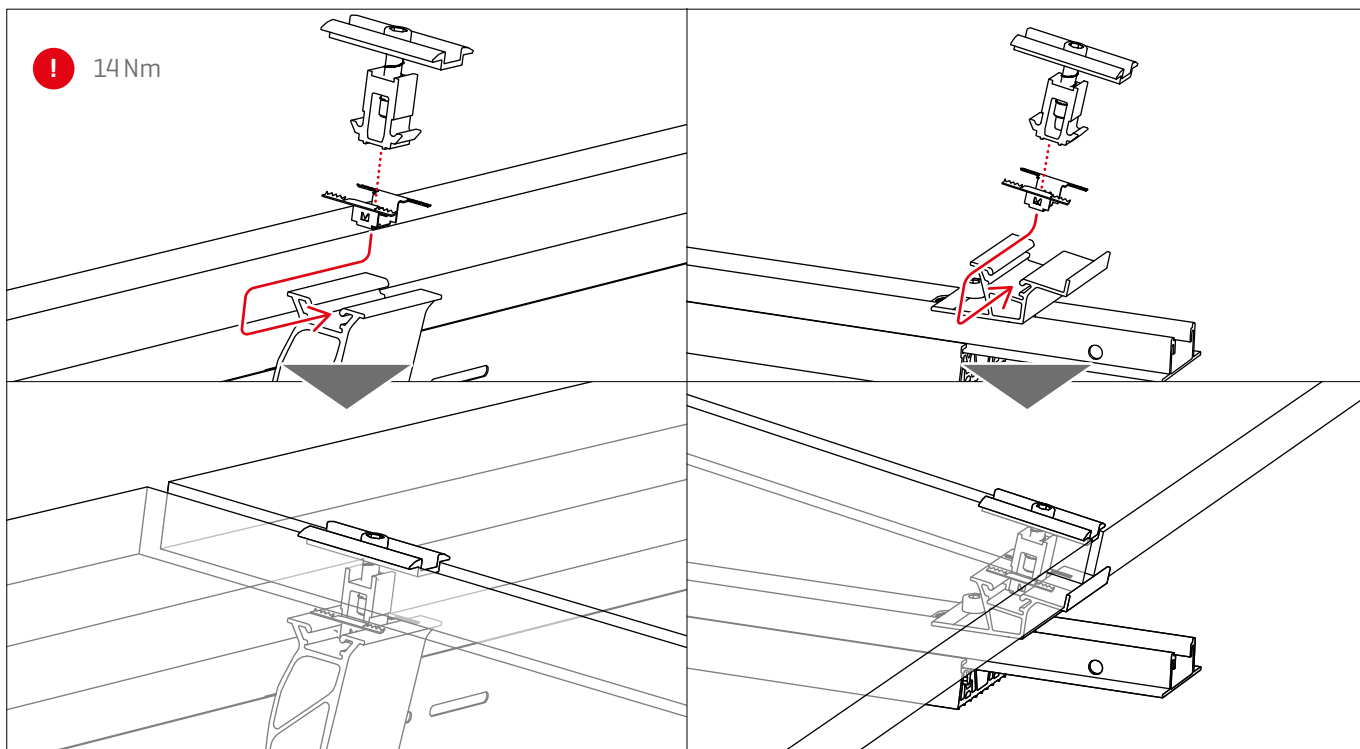

## Notes



## Notes

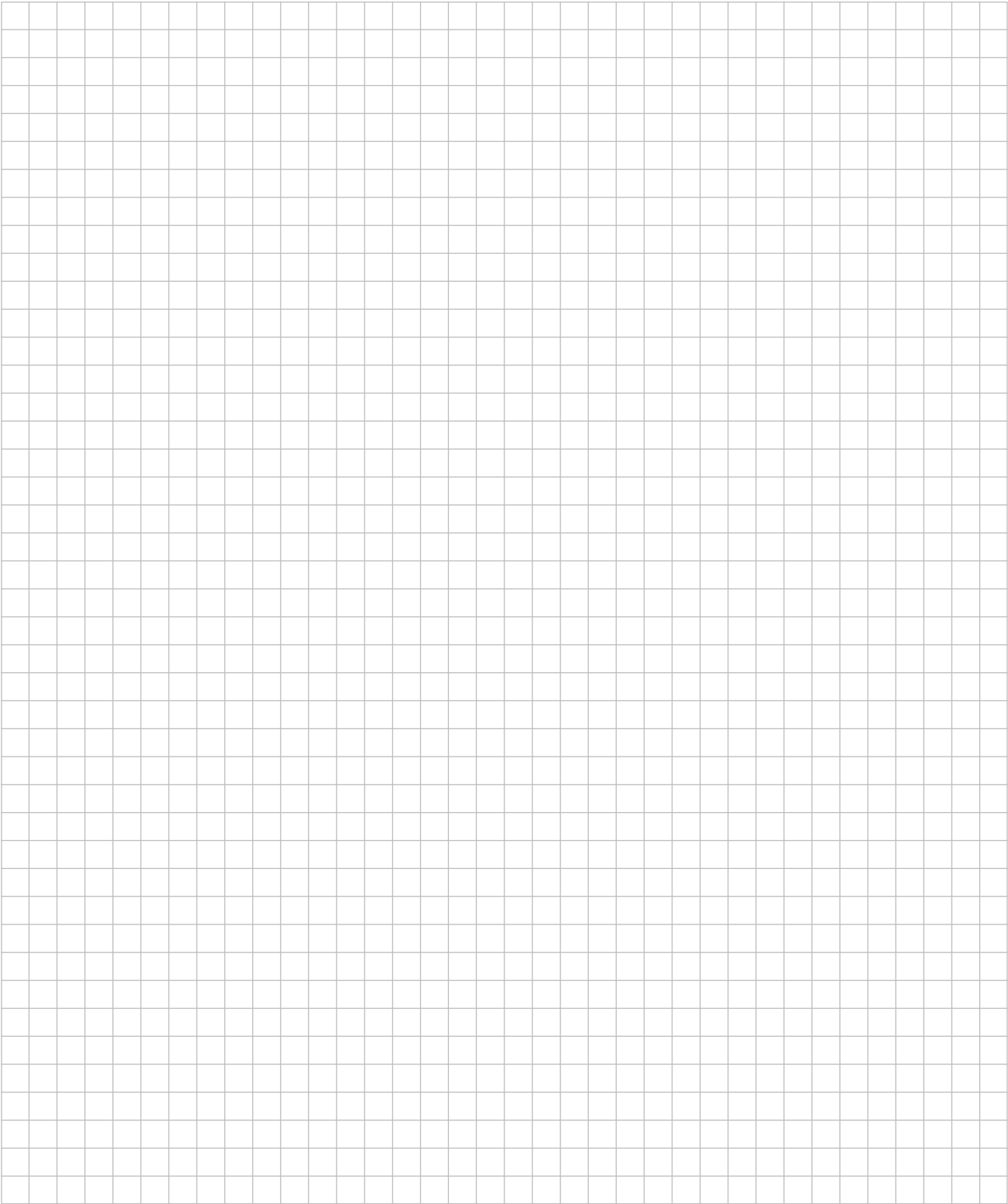

## We support PV systems



## Thank you for choosing a K2 mounting system.

Systems from K2 Systems are quick and easy to install. We hope these instructions have helped. Please contact us with any questions or suggestions for improvement.

Our contact data:

- ▶ **[k2-systems.com/en/contact](https://k2-systems.com/en/contact)**
- ▶ **Service Hotline: +49 [0]7159 42059-0**

German law shall apply excluding the UN Convention on CISG. Place of venue is Stuttgart.

Our General Terms of Business apply. Please refer:  
[k2-systems.com](https://k2-systems.com)

**K2 Systems GmbH**

Industriestraße 18  
71272 Renningen  
Germany

+49 [0] 7159 - 42059 - 0  
[info@k2-systems.com](mailto:info@k2-systems.com)  
[www.k2-systems.com](https://www.k2-systems.com)